

# Transit Alternatives



## PikeRide

- Quality bus service that accommodates existing travel demand
- Flexible service
- Significant limitation for service expansion to accommodate future corridor growth
- Low potential to serve as a catalyst for development
- Low potential for private-sector funding support
- Low capital costs

## Baseline Alternative



# Transit Alternatives



**BRT Alternative**

## Bus Rapid Transit (BRT)

- Quality service that accommodates demand
- Flexible service
- Limited capacity for service expansion to accommodate future corridor growth
- Limited potential to serve as a catalyst for development
- Limited potential for private-sector funding support
- Medium capital costs



# Transit Alternatives



**Streetcar Alternative**

## Streetcar

- High quality service that accommodates demand
- Higher capacity for service expansion to accommodate future corridor growth
- Higher potential to serve as a catalyst for development
- Higher potential for private-sector funding support
- More broadly recognized as a premium, lasting investment
- High capital costs



# Selection of Preferred Alternative



+



## Modified Streetcar Alternative (Initial Phase)



## Modified Streetcar Alternative

- Combines characteristics of streetcar and baseline alternative (with continued extensive bus service)
- Benefits evenly spread along corridor
- Achieves a more affordable initial streetcar investment
- Catalyst for development along corridor



# Selection of Preferred Alternative: Service Enhancements

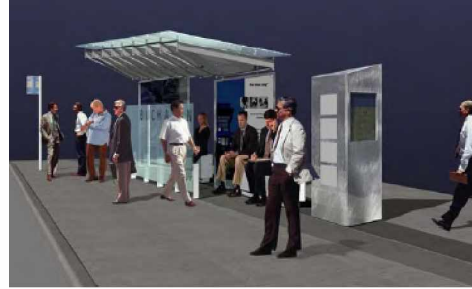

## PIKE TRANSIT IMPROVEMENTS



# Selection of Preferred Alternative: Funding



## Preferred Alternative Would Require a Combination of Funding Sources

### Potential Federal Transit Administration (FTA) Funding

- Potential candidate for new Small Starts Program
- Emphasizes economic development and quality of life
- Less competitive for existing FTA New Starts Program

### Potential Non-Federal Funding

- State and county revenues
- Public-private partnerships
- Value capture
- Joint development
- Advertising and sponsorship

# Next Steps

---



- Select a preferred alternative
  - Arlington County Board, April 22
  - Fairfax County Board of Supervisors, May 1
- Develop funding strategies
- Conduct environmental assessment and preliminary engineering
- Update Constrained Long Range Plan to include the Columbia Pike Transit Project (MWCOCG)
- Design and implement preferred alternative

# Case Studies: How Streetcars Have Worked in Other Communities



Announcing that the Tampa Streetcar project was going to be implemented resulted in heightened development activity all along the corridor.  
- Hillsborough Area Regional Transit



PRE-CONSTRUCTION PRICING! FROM THE 300s.

**VENTANA**  
CITYSIDE, CHANNELSIDE, WATERSIDE.

**WINDOW OF POSSIBILITIES**

Ventana offers 84 intimate residences, along with a collection of refreshing amenities and its own unique mix of boutique retail conveniences...all in an urban oasis.

The residences feature open and spacious floorplans, along with sprawling picture windows drawing an abundance of natural light. Generous verandahs showcase expansive views.

call Mark at  
727-946-9566

Upgraded features and amenities include two reserved parking spaces per residence in Ventana's secure garage, as well as a climate-controlled personal storage locker, pool and spa, sauna, clubroom and fitness center. Don't miss this window of opportunity.

High-quality transit services provide a major impetus for transit-oriented development, which results in attractive, safe, walkable, mixed-use neighborhoods that add excitement, vitality, diversity and economic value to nearby properties. - American Public Transportation Association



# Case Studies: Portland Streetcar



Since the original Portland streetcar alignment was identified in 1997:

- Over \$2.8 billion invested within two blocks of the alignment
- 7,248 new housing units and 4.6 million square feet of office, institutional, retail, and hotel space
- 55% of all downtown development has occurred within one block of the alignment

- Portland Streetcar Development Oriented Transit Report, January 2006

